

### Unpacking Guide

**Note:** The ink cartridge and media roll may be shipped in a separate box. Locate and install the ink cartridge and sample media as indicated in these instructions.

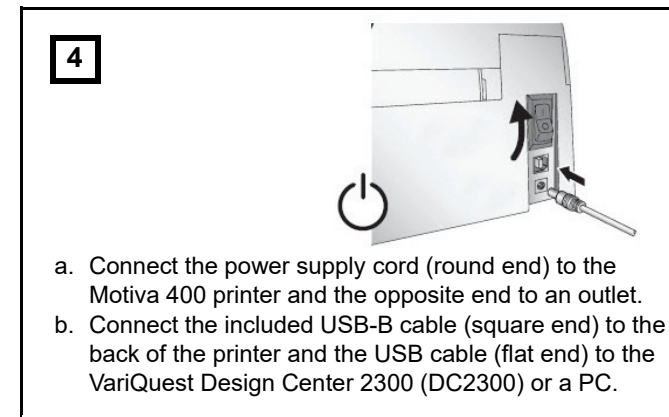
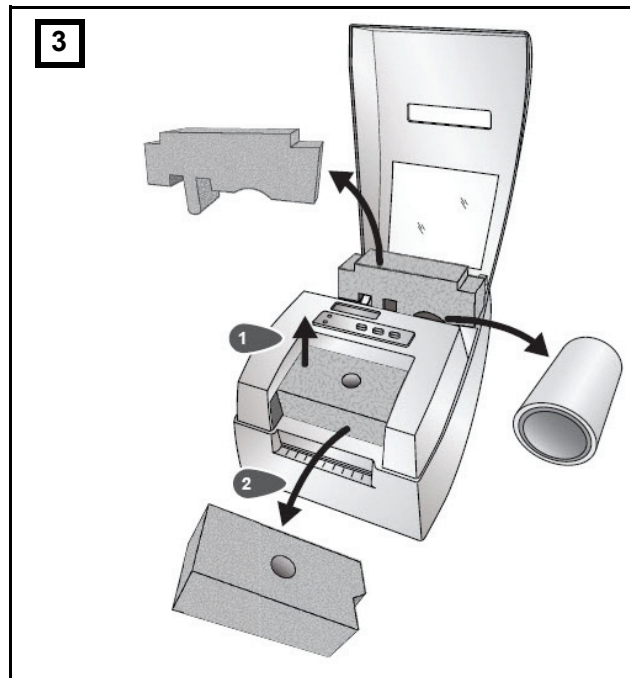
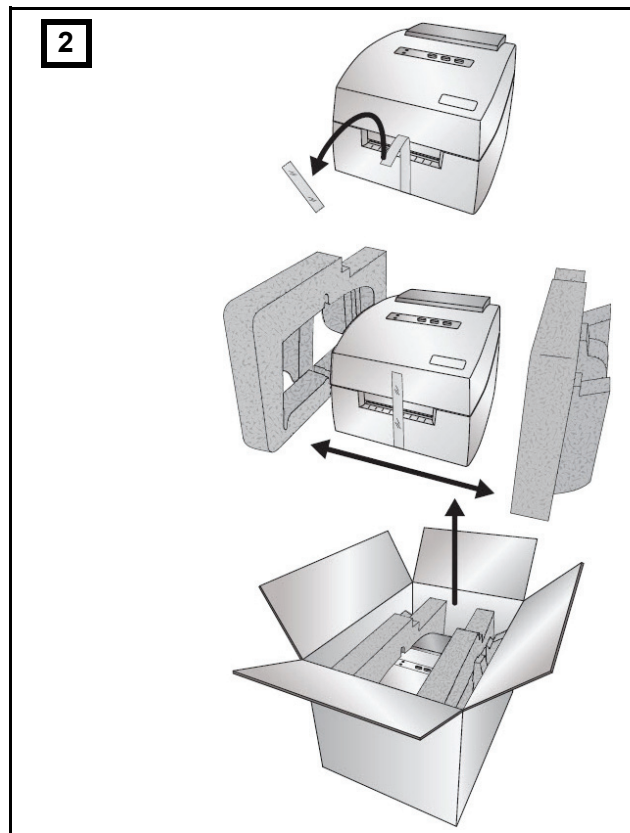
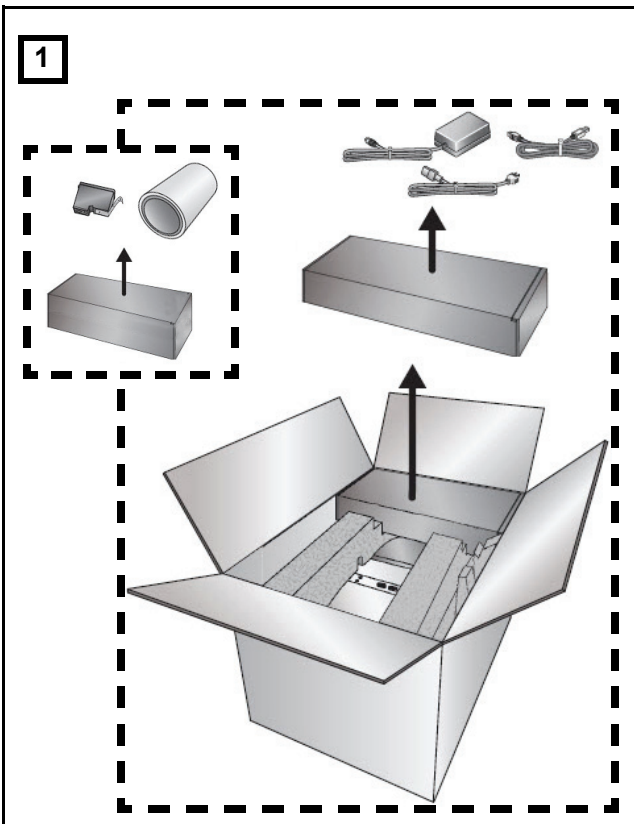

- Connect the power supply cord (round end) to the Motiva 400 printer and the opposite end to an outlet.
- Connect the included USB-B cable (square end) to the back of the printer and the USB cable (flat end) to the VariQuest Design Center 2300 (DC2300) or a PC.

**Note:** Drivers and utilities are preinstalled on the DC2300 and included on the VariQuest Software DVD.

**Note:** Refer to the VariQuest Design Center Software User's Guide for details about using the software with the printer.

### Technical Support

For technical assistance, please contact your authorized VariQuest dealer or the VariQuest Technical Support team:

- **Email:** [techsupport@variquest.com](mailto:techsupport@variquest.com)
- **Phone:** 1-800-328-0585