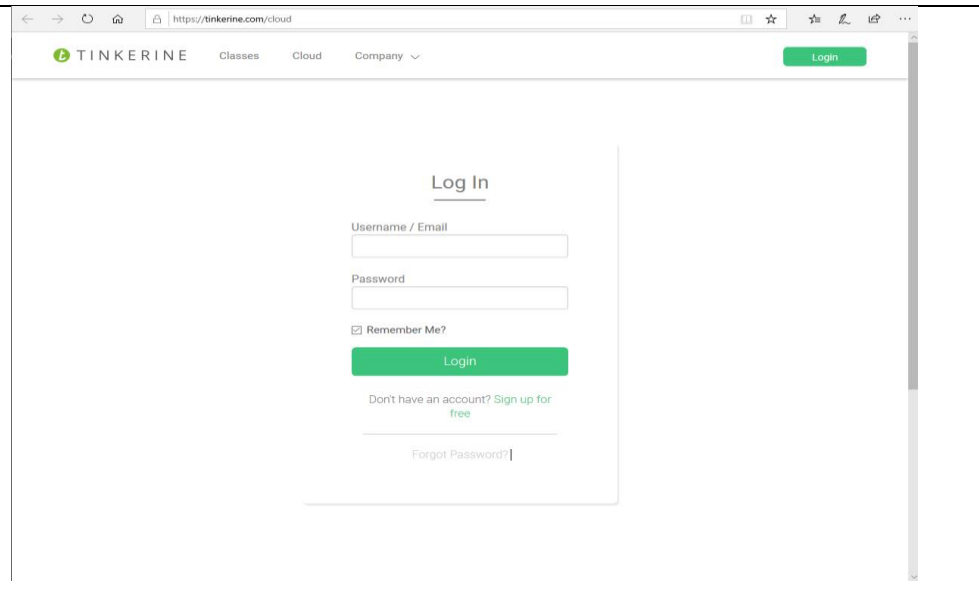
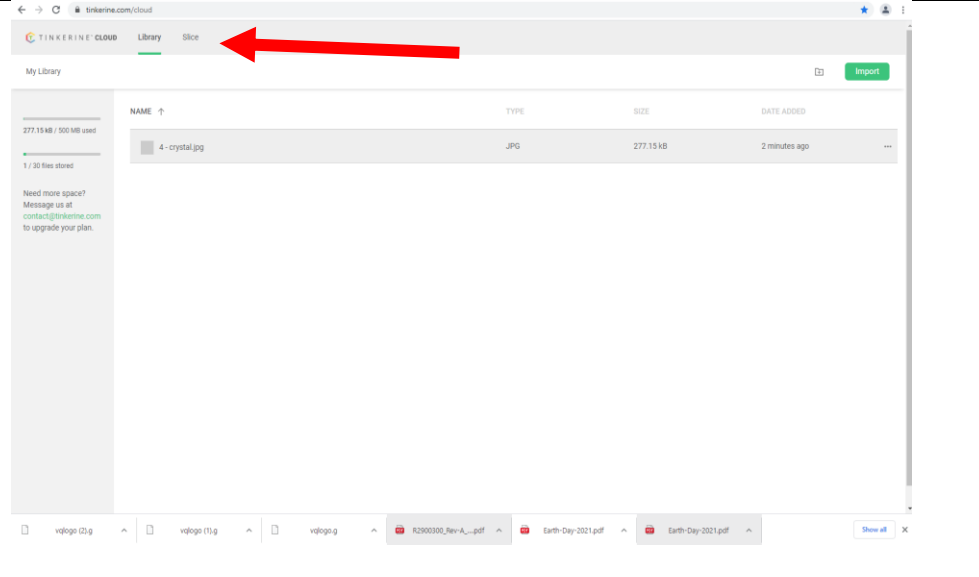

OVERVIEW

Tinkerine™ Cloud provides customers using Chromebooks the ability to prepare files for printing to Trifecta® 800, without having to load the Trifecta® Software on another PC. The guide below provides basic instructions on how to upload and prepare files for printing. Please refer to the [Trifecta 800 User's Guide](#) for additional information on print settings.

STARTING THE TINKERINE CLOUD SOFTWARE

<ol style="list-style-type: none"> 1. Open a browser window on your Chrome system. 2. Copy/Paste the following link: https://tinkerine.com/cloud 3. This will open a web page on the Tinkerine Cloud website. Please click “Sign up for free” to set up an account 	
<ol style="list-style-type: none"> 4. Once you have set up an account and logged in, then you will see a screen with your “Library” which shows all your models that you have imported and gives you the option to import more. 5. You can then click on Slice in the upper left to view the Tinkerine Cloud operating screen 	

- Once you have clicked on **Slice**, the screen should look like this. This is where you will be able to import your model for editing and customization.

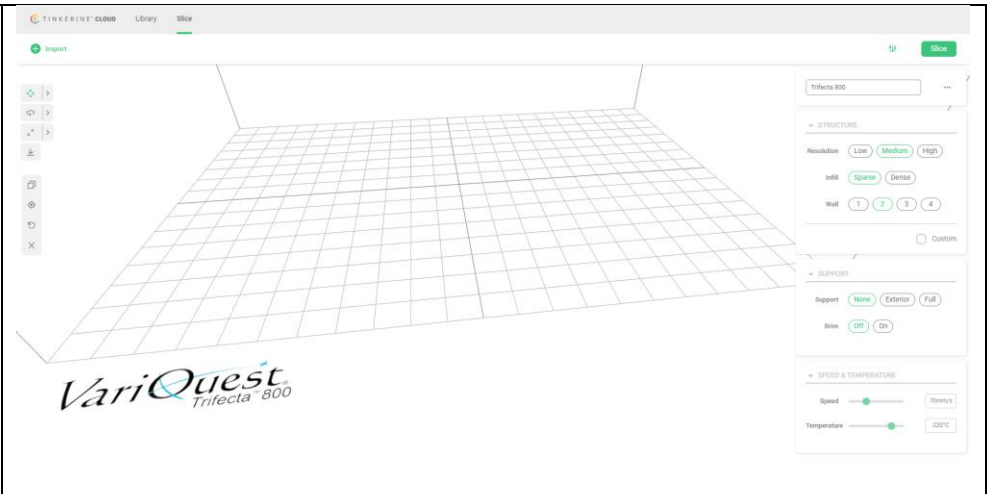

LOADING MODEL FILE INTO TINKERINE CLOUD

1. Select the Trifecta 800 printer through the dropdown.
2. Press the Import button.

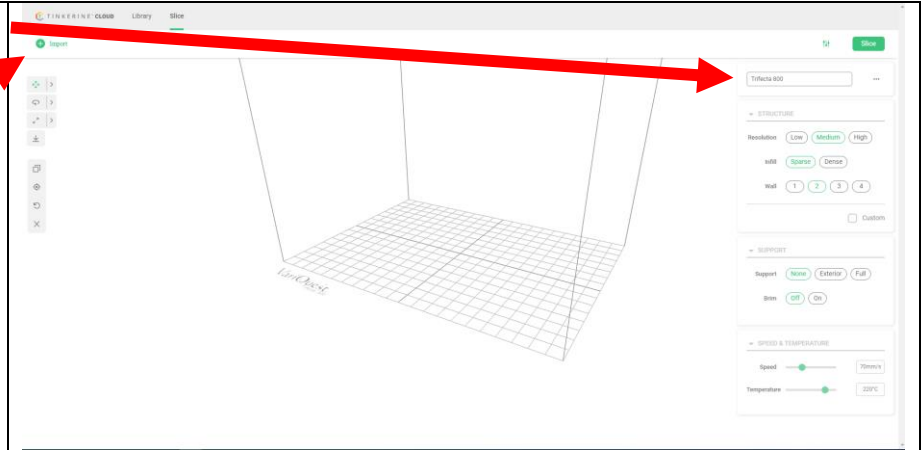

3. Your file folders will appear and you will be able to select which model you would like to import and then click open. Your model should now be present in your software

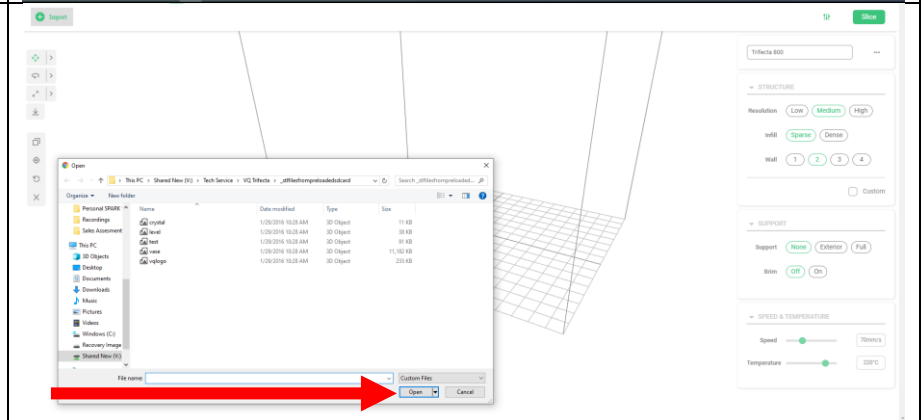

4. Your model should now be viewable in the Tinkerine Cloud application.

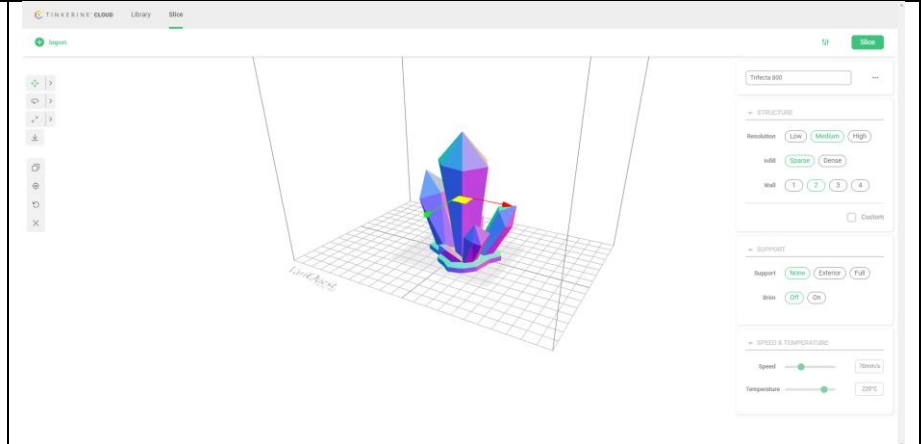

EDITING THE MODEL

<ol style="list-style-type: none"> 1. On the left side of the screen, you should be able to: <ol style="list-style-type: none"> 1. Translate: adjust the location of the model on the platform 2. Rotate the model 3. Scale the model to any size 4. Lay flat 5. Duplicate 6. Center 7. Reset 8. Delete 	
<ol style="list-style-type: none"> 2. On the right side of the screen, you should be able to edit: <ol style="list-style-type: none"> 1. Hardware: includes printer selection 2. Structure: includes resolution (thickness of layer), infill (% of inside of model filled), and the amount/thickness of walls 3. Support: includes support of exterior or full (interior & exterior) and brim 4. Speed & Temperature: includes speed and temperature of printing 	

SLICING THE MODEL

1. Press the slice button

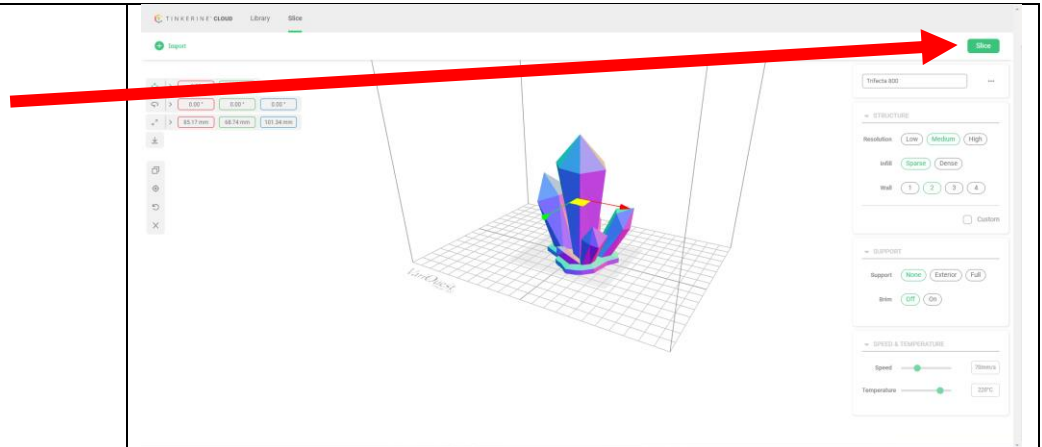

2. The sliced model will be shown along with an estimate of material used and model print time.

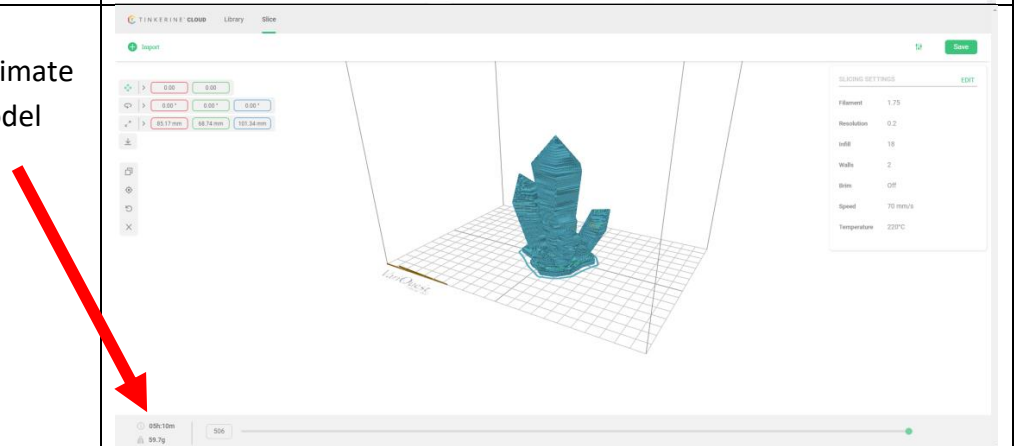

SAVING THE G CODE FILE TO YOUR SD CARD

1. Press the “Save” button.

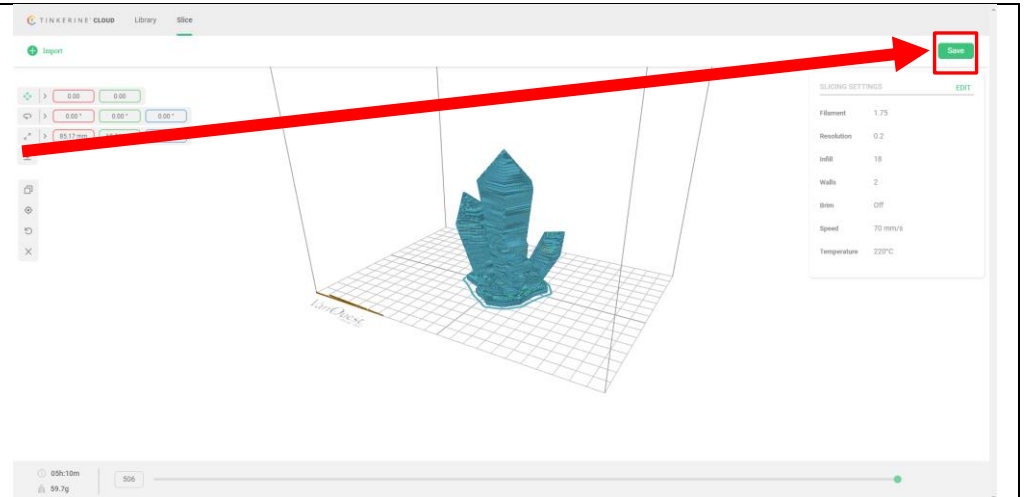

2. The file will then download to your computer, and you should see it appear in the bottom left as a G code.

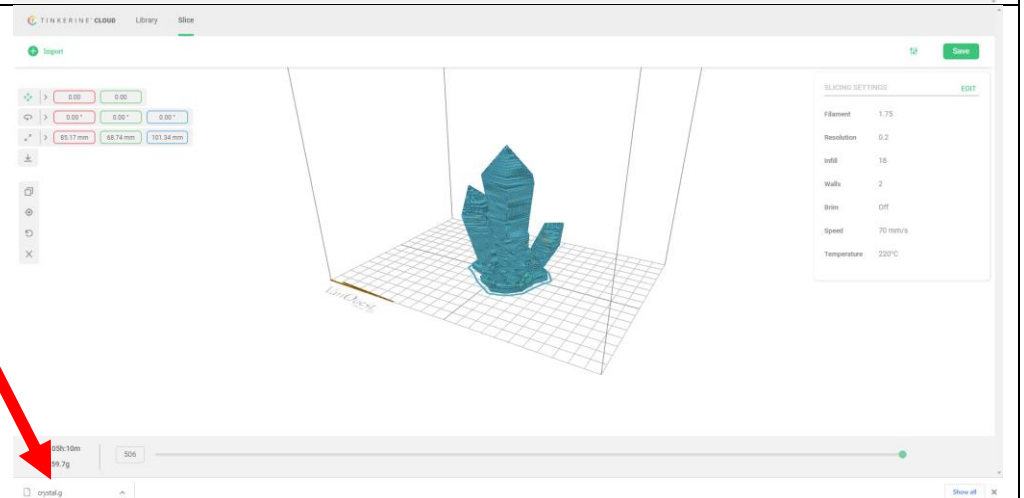

3. Open your file folder, choose the file, and save it to your SD card so you can transfer it to the Trifecta 800 for printing.

